

Tender No - SFURTI-I/MGH-MMCS/ P&M-001/2021-22 - Supply, Installation And Commissioning Of Oyster Mushroom Spawn Lab, Processing & Value Addition Cluster at Mendipathar, North Garo Hills, Meghalaya

RESPONSE TO PRE-BID QUERIES

S. No.	Query	Response
1.	Transformer - Power Control Panel - Kindly provide the load calculation designs so that the panel can be designed for Incoming & outgoing Loads Circuit Breakers etc	The load distribution has already been calculated based on the project requirement. The details on panel design/ specification is being provided as part of the addendum to the tender document.
2.	Rainwater Harvesting - Please provide the building design so that estimation can be done for bringing the rainwater through down pipes	Drawing is being provided as part of the addendum to the tender document.
3.	Page 2 says last date of submission on 30 Aug; however page 6 says 23.08.2021. Please Clarify	30 th August 2021 is the last date of bid submission
4.	Is Electric motor/ diesel Engine required for the chaff cutters	Yes
5.	Incubation room dimension - Is there any layout, technical drawings. Does the PUF Insulated panel require Brick wall as well?	Spawn lab layout and drawing is being issued as addendum to the tender document. Brick work is in the scope of work of contractor. Same is under implementation.
6.	Transformer comes in 315 kva - is Copper wound or aluminium wound required. Also share step down of transformer would be from 33 KVA line or 11 KVA - Is transformer pad within scope of bidder? Who shall do the earthing	Copper wound is required. Step down transformer will be 11 KVA line. Pole mounted transformer to be installed.
7.	Power Panel Can only be designed if the load distribution is available. Please share the details	The load distribution is being provided as part of the addendum to the tender document.
8.	Is wiring between panel/DG/Transformer in scope of bidder? How about from Panel to various machines - If yes, please share all wiring/cablings details	Wiring b/w DG, transformer and panel is in the scope of work of the bidder. However, all wiring from panel onwards to machines / sections etc is not in scope of work for transformer/ DG set supplier
9.	DG set requires Earthing - Whose scope, is it? Is auto start/off feature required in DG	Yes, auto start/ off feature is required. However, bidder may give its proposed design/ specification for consideration by the technical team justifying the utility and longevity of the proposed equipment.

Smta Rix Kogathakara

SECRETARY
Mendipathar Multipurpose
Co-op Society Ltd

Sjay



Lucky Princy A. Monim



Tender No - SFURTI-I/MGH-MMCS/ P&M-001/2021-22 - Supply, Installation And Commissioning Of Oyster Mushroom Spawn Lab, Processing & Value Addition Cluster at Mendipathar, North Garo Hills, Meghalaya

10.	Rainwater Harvesting - Please share more details - Building layout Drawing from where will rain water be collected	Drawing is being shared as part of Addendum to the tender document.
11.	Water Treatment and recycling plant - 100 m3 per day recycle system which consist of black & grey sewage - are they to be reused?	Only water from the cold pasteurization system is going to be reused. 80% of the treated water will be reused in the facility. 20% of the water will be softened before it is discharged. The system must include complete mechanical filtration system for the 100 m3 water recycling system and all piping and installation.
12.	Water Treatment and recycling plant - 20m3 water discharge system - What kind of water are we talking of?	
13.	Water Treatment and recycling plant - 20m3 / day water softening plant - Will require water test report for effective design and quotation	
14.	CCTV - requirement speaks of a computer - What is the purpose - Please share specifications for the same	Integrated computer system with suitable provision for the periodic (interval of one month) back up of data in DVD for Fixed camera – 16 channel system. OR In case the cameras have in-built pen drive system to take back up and recordings, then a separate computer system in not required.
15.	CCTV - HD Space is not mentioned, is Power Back UP reqd, Monitor size not mentioned. if yes please share specs, Document speaks of remote connectivity. Provision for Internet should be made available at site	HD drive – as per system requirement. Yes, power back up required. Yes, internet connectivity will be made available at site
16.	CCTV - Placement of camera is not mentioned, hence would require drawings along with kind of wiring required (Naked, casing, concealed)	Fixed – 240 degree (night vision) – bullet camera (weatherproof): 4 nos. to be installed outside the facility including parking area. Fixed – 240 degree (night vision) - doom camera: 12 nos. for inside the facility ie. Lab, bag section, Admin & account, dehydration & VA section, Pre-processing area etc.
17.	It would be great if you can share the detailed drawings along and layout for the bidder to place the quotes properly. Also group wise estimated cost would help us bid at the right level	Section wise plan is being issued as Addendum to the tender document. Group wise cost estimation is as under: Group 1: Bag Making & Filling Section: INR 56.71 Lakh Group 2: Dehydration, Powder making & Packaging Section: INR 67.86 Lakh Group 3: Spawn Lab Section: INR 89.75 Lakh

Sister Rose Kogathakara

SECRETARY
Mendipathar Multipurpose
Co-op Society Ltd

Sjay



Luckyfrancy A. Monin



Tender No - SFURTI-I/MGH-MMCS/ P&M-001/2021-22 - Supply, Installation And Commissioning Of Oyster Mushroom Spawn Lab, Processing & Value Addition Cluster at Mendipathar, North Garo Hills, Meghalaya

		Group 4: Utilities Section: INR 29.01 Lakh
18.	After sterilization in Autoclave wheat should be cooled by spreading on floor/ stretcher OR by mechanical cooling system. For which one unit is required to be added. Mechanical cooling system should be accepted to avoid contamination by hand touch.	No separate cooling system is included in the current design. the cooling will be done through natural cooling process. In case you have a better solution please add it in your bid as additional suggested items. please explain the working of your suggested equipment and the advantage of using this system. Please also include the price of the product in the price bid as well in the category of additional suggested items but not to be included in the total price bid. This equipment will be separately evaluated based on technical and price parameters and may be purchased separately if budget permits.
19.	In dehydration, packing section, in item No. 11, Tray dimension is given as 24"x18"10". Is there any typing mistake? Tray height always be max 2 to 4". Please confirm.	Specs amended. Depth for the Tray to be kept as 4"
20.	Electric heater-based dehydration unit capacity is given as 500 kg per batch. If 500 kg mushroom is required to be accommodated at a time, drier will be very big wherein Air circulation will not be so good as a result of which drying time will be very long. Moreover, the size of the drier will be so big and it will be very difficult to transport and get entry into room.	No change in specification. Tray area requirement remains same. You may give your proposed design for consideration by the technical team.
21.	80 m2 (845 sq.ft) area is suggested for 500 kg mushroom, oyster mushroom should be distributed for better drying in an area @ 84 sq.ft for maximum 38 to 40 kg. Thus, in total area of 845 sq. ft or 80 sq. mtr, maximum 400 kg mushroom can be accommodated for better drying.	No change in specifications. Tray area requirement remains same. You may give your proposed design for consideration by the technical team.
22.	Biomass based cold storage requires electricity to be generated by Gasifier. Hence it is suggested to think about solar based cold storage although in Meghalaya which is cloud prone area, effectiveness of Solar may be difficult. Off grid or On grid solar system may be the solution to run cold storage apart from electricity.	No change in specifications. Cold room is biomass based. Solar based will not be considered.
23.	Portable Field Straw Cutter operated by 3 Hp Diesel Engine can give a production of 50 kg per hour. Hence 5 Hp Diesel engine is not required.	No change in specifications. You may provide additional details of 3 HP system as additional suggested design for consideration by technical team.
24.	7.5 Hp Motor Straw cutter is capable to cut dry straw @ 1000 to 1200 kg per hour. Hence, 10 Hp motor operated unit may not be required.	No change in specifications. You may provide additional details of 7.5 HP system as additional suggested design for consideration by technical team.

Santa Rix Kogathakara

SECRETARY
Mendipathar Multipurpose
Co-op Society Ltd

Sjay



Luckyfrancy A. Monim



Tender No - SFURTI-I/MGH-MMCS/ P&M-001/2021-22 - Supply, Installation And Commissioning Of Oyster Mushroom Spawn Lab, Processing & Value Addition Cluster at Mendipathar, North Garo Hills, Meghalaya

25.	General Plat layout where the machine to be installed with total available area for each Group/Section. <ul style="list-style-type: none"> For positioning of processing machinery, since few machineries requires Foundations. For General idea of exhaust system 	Layout drawings (section wise) is being shared as part of the addendum to the tender document.
26.	Firms registered with MSME; do they also need to submit the EMD	No. All MSEs and/ or firms registered with MSME are exempted from EMD. Only certificate of registration is required to be submitted along with the bids
27.	What is payment mechanism?	Payment mechanism is part of the tender document detailed out in clause No. 16 of the tender document
28.	What is the value of Performance Security that successful bidder will need to submit?	Performance security will be calculated @ 3% of the contract value of the successful bidder. Same shall be submitted in form Bank Guarantee form a Scheduled Commercial bank.
29.	Do we need to submit the copies of Financial Bid also	No. Financial bid will only be submitted in original. However, Technical bid will be submitted in Original and Duplicate.

Sister Rose Koyathakara

SECRETARY
Mendipathar Multipurpose
Co-op Society Ltd

Sjay



Luckyfrancy A Monim

Tender No - SFURTI-I/MGH-MMCS/ P&M-001/2021-22 - Supply, Installation And Commissioning Of Oyster Mushroom Spawn Lab, Processing & Value Addition Cluster at Mendipathar, North Garo Hills, Meghalaya

ADDENDUM NO. 1

LAYOUT DRAWINGS OF THE FACILITY SECTIO WISE

PROPOSED OVERALL SITE PLAN

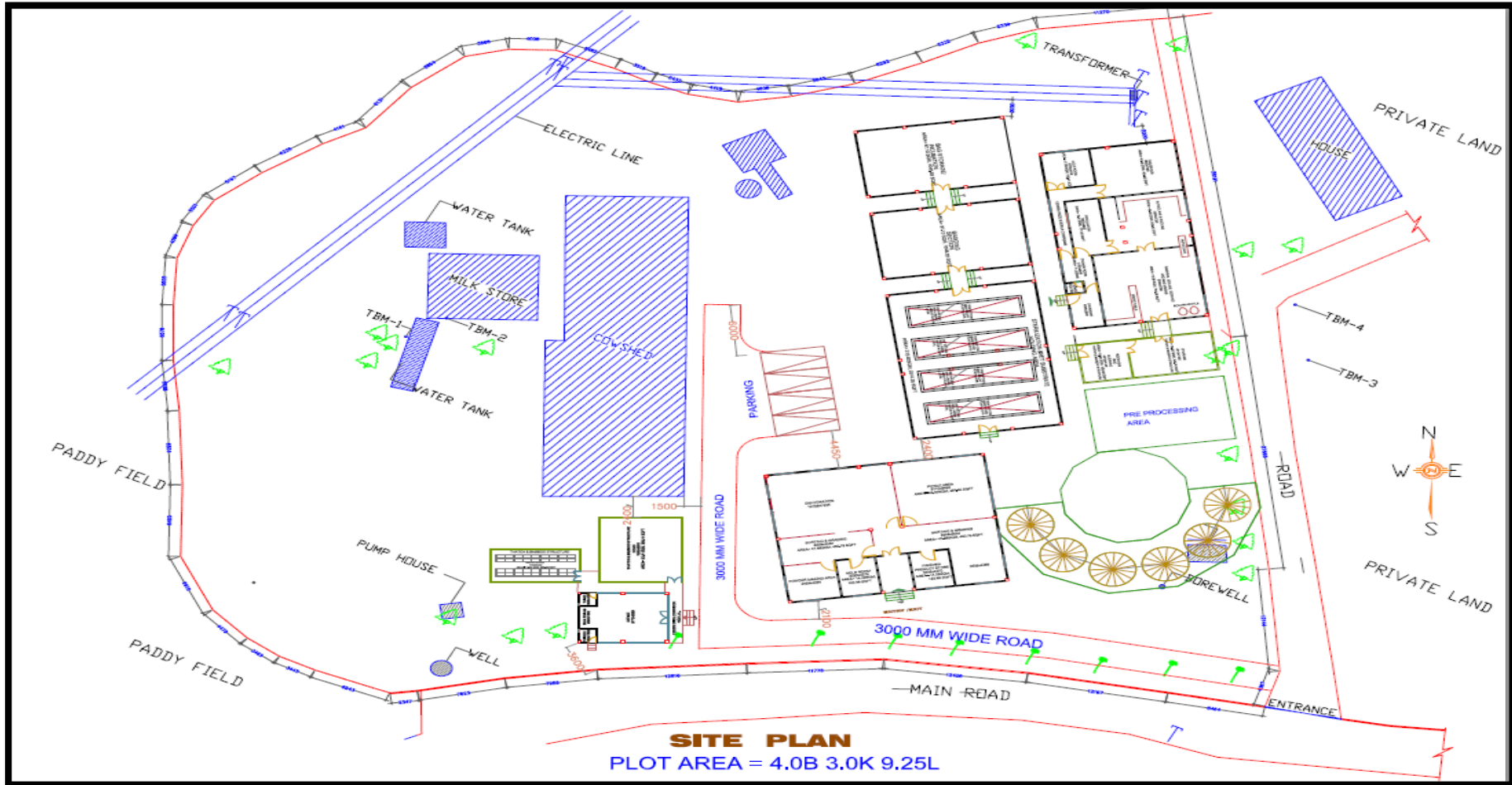

Sister Rox Kogathakara
SECRETARY
Mendipathar Multipurpose
Co-op Society Ltd

Sjay

Shreeta
Mendipathar Multipurpose
Co-op Society Ltd

Luckyfrancy & Homim



Tender No - SFURTI-I/MGH-MMCS/ P&M-001/2021-22 - Supply, Installation And Commissioning Of Oyster Mushroom Spawn Lab, Processing & Value Addition Cluster at Mendipathar, North Garo Hills, Meghalaya

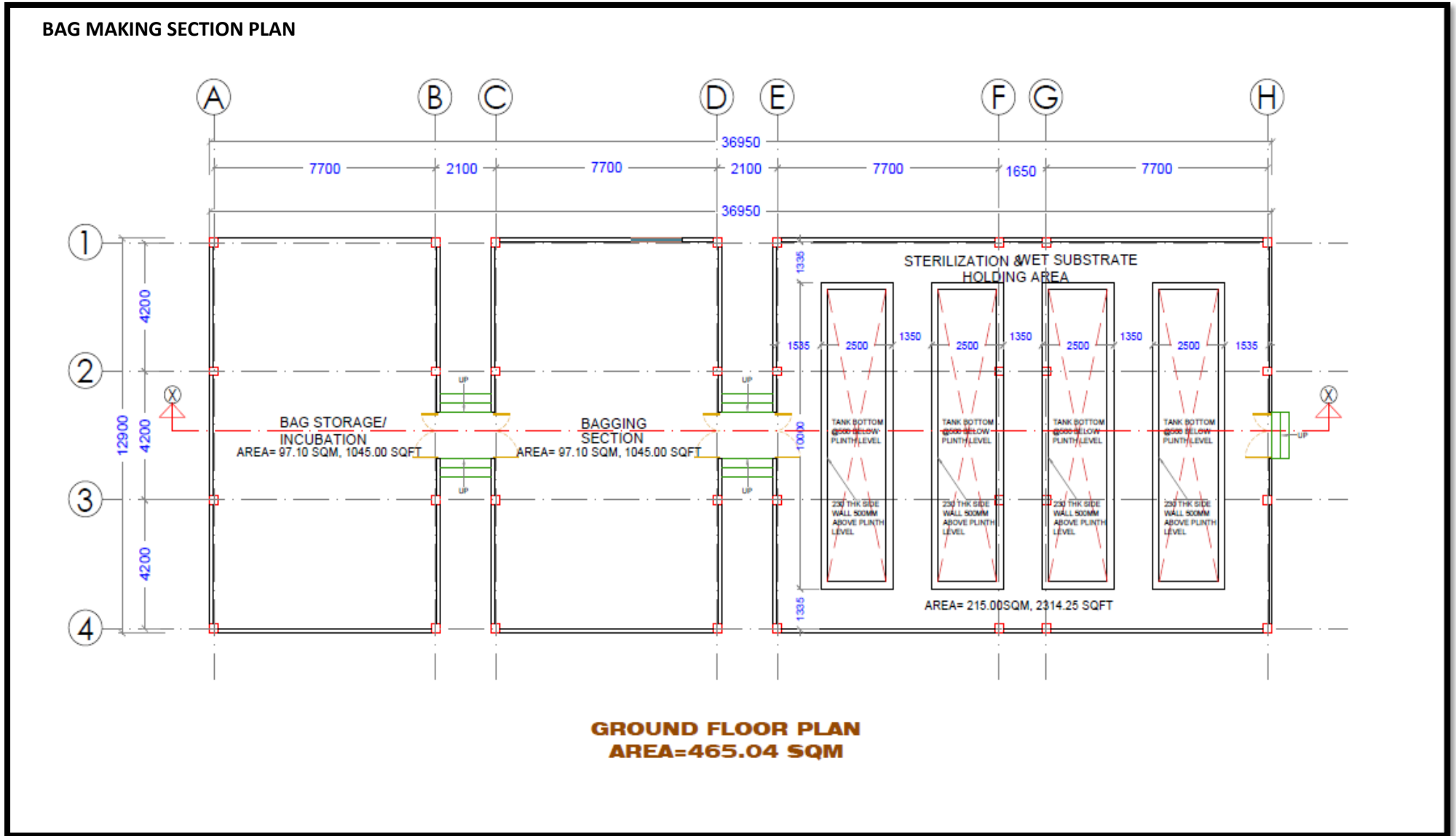

Sister Rose Koyathakara

SECRETARY
Mendipathar Multipurpose
Co-op Society Ltd

Sjay



Luckyfrancy a Monin



Tender No - SFURTI-I/MGH-MMCS/ P&M-001/2021-22 - Supply, Installation And Commissioning Of Oyster Mushroom Spawn Lab, Processing & Value Addition Cluster at Mendipathar, North Garo Hills, Meghalaya

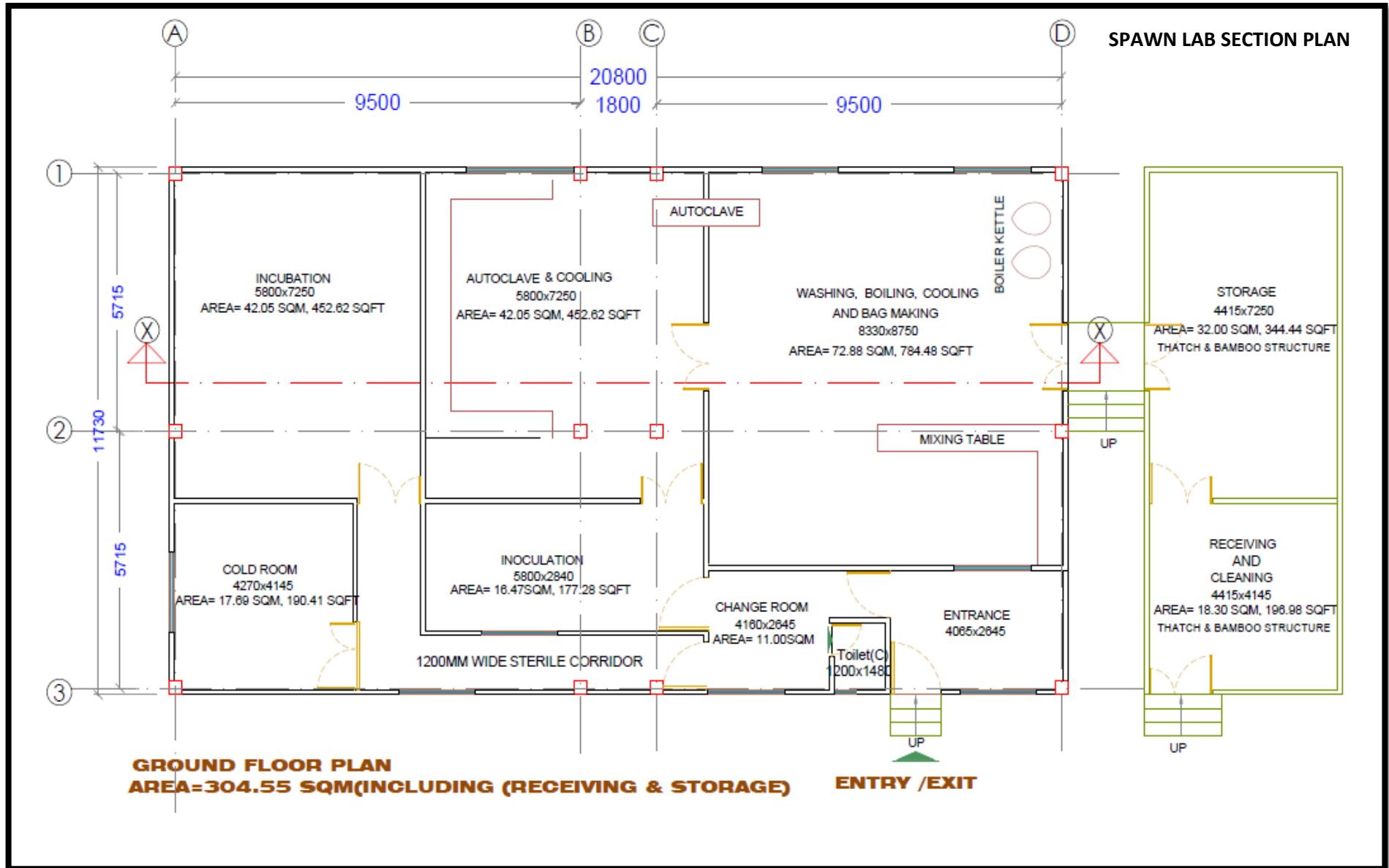

Xolan Kox Kogathakva

SECRETARY
Mendipathar Multipurpose
Co-op Society Ltd

Sjay

Shute

Luckyfrancy a Homim

Tender No - SFURTI-I/MGH-MMCS/ P&M-001/2021-22 - Supply, Installation And Commissioning Of Oyster Mushroom Spawn Lab, Processing & Value Addition Cluster at Mendipathar, North Garo Hills, Meghalaya

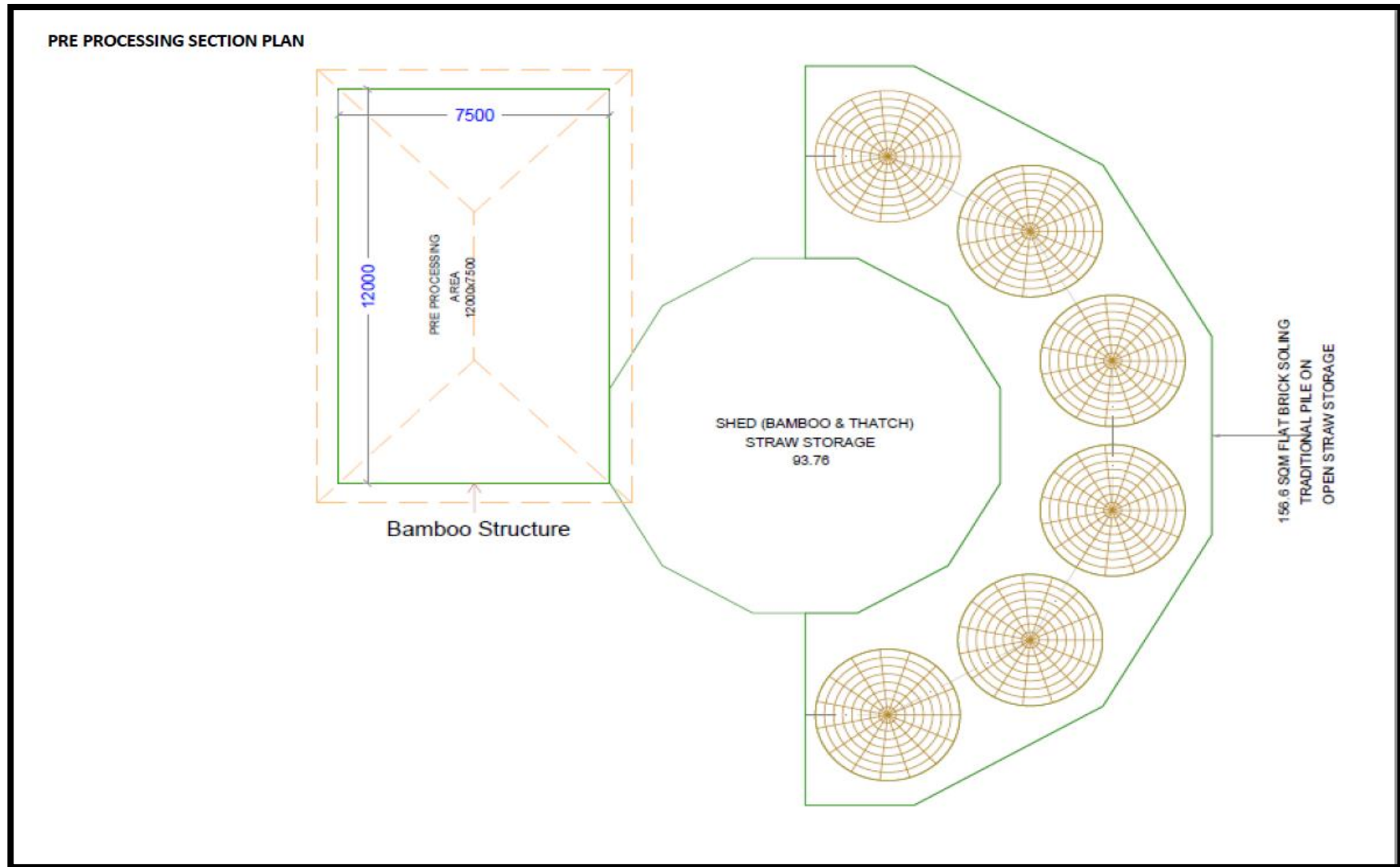

Sister Rose Koyathakara
SECRETARY
Mendipathar Multipurpose
Co-op Society Ltd

Sjay

Shreeta

Luckyfrancy A. Monim

Tender No - SFURTI-I/MGH-MMCS/ P&M-001/2021-22 - Supply, Installation And Commissioning Of Oyster Mushroom Spawn Lab, Processing & Value Addition Cluster at Mendipathar, North Garo Hills, Meghalaya

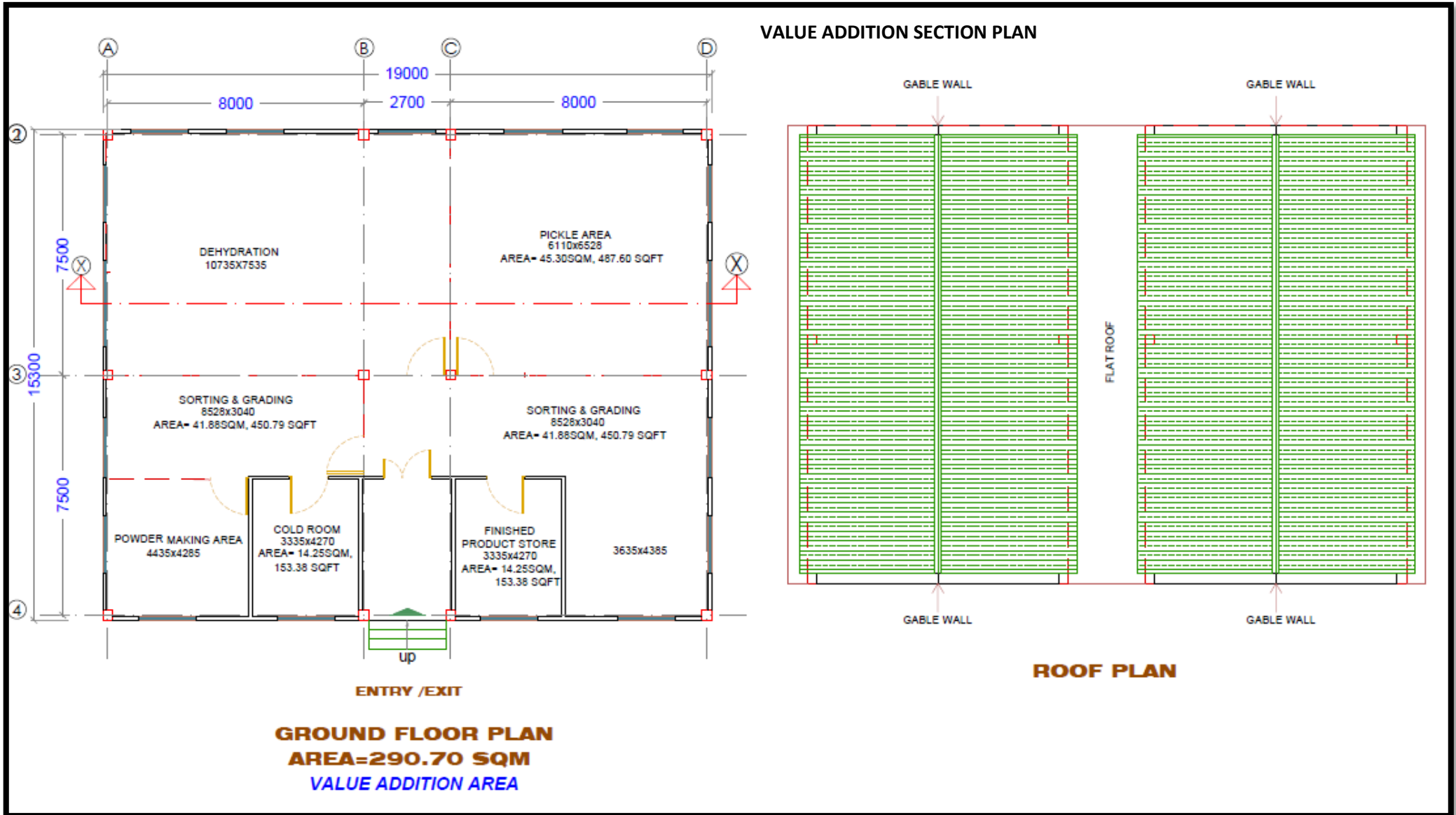

Sister Rose Koyathakara

SECRETARY
Mendipathar Multipurpose
Co-op Society Ltd

Sjay

Shreeta

Luckyfrancy & Monim



Tender No - SFURTI-I/MGH-MMCS/ P&M-001/2021-22 - Supply, Installation And Commissioning Of Oyster Mushroom Spawn Lab, Processing & Value Addition Cluster at Mendipathar, North Garo Hills, Meghalaya

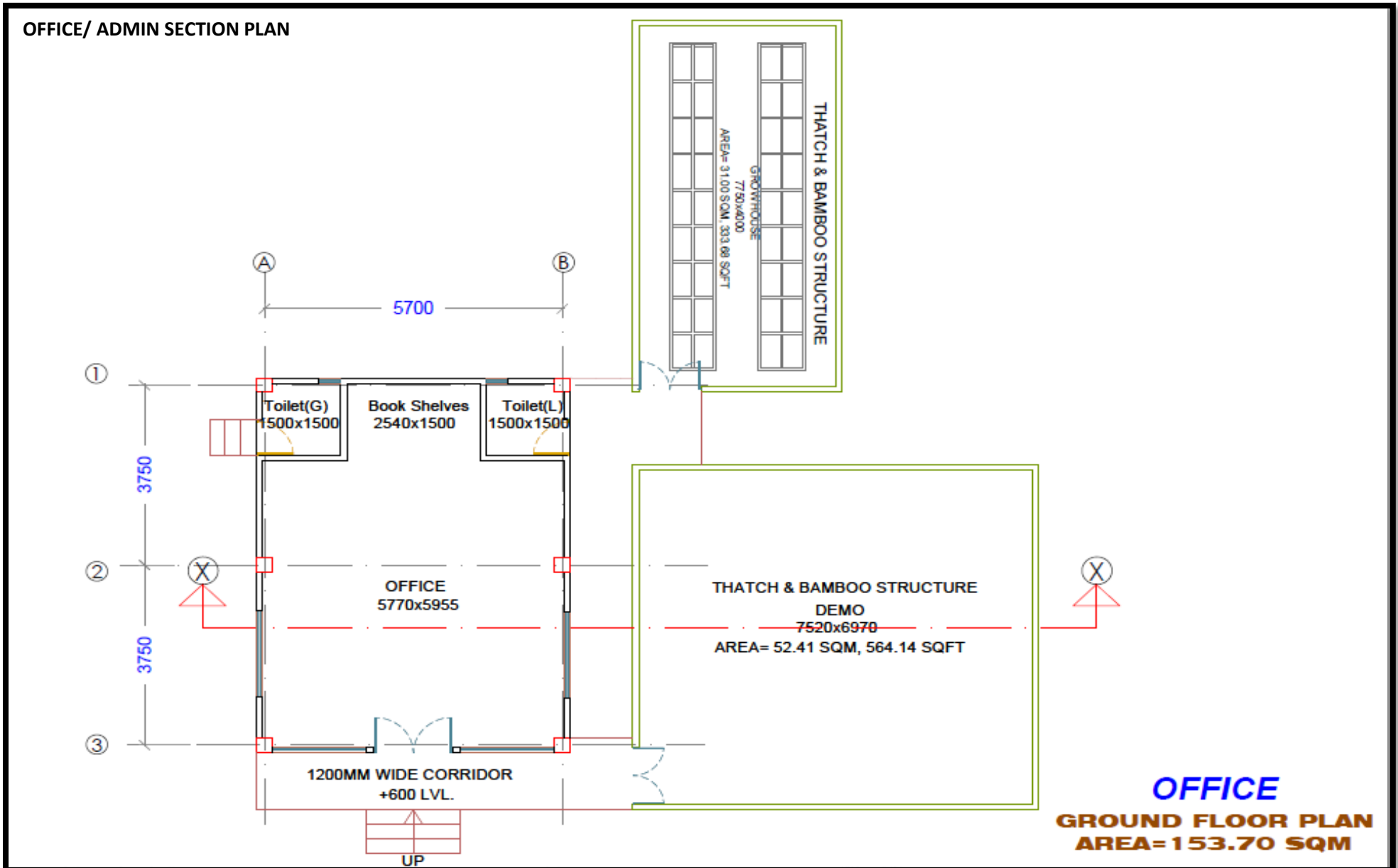

SECRETARY
Mendipathar Multipurpose
Co-op Society Ltd

Sjay

Shete

Luckyfrancy & Homier

Tender No - SFURTI-I/MGH-MMCS/ P&M-001/2021-22 - Supply, Installation And Commissioning Of Oyster Mushroom Spawn Lab, Processing & Value Addition Cluster at Mendipathar, North Garo Hills, Meghalaya

TRANSFORMER PANEL LOAD REQUIREMENT/ SPECIFICATIONS

SI No.	DESCRIPTION	Units	Qty
1	MAIN LT FEEDER PANEL		
	Supplying and installation of metal enclosed free standing floor readable mounted front operated cubical type switch gear panel suitable for OUTDOOR Type installation conforming to IS: 8623 (Part I & II). Panel should be made of sheet steel and thickness not less than 2mm and structural steel having light section with arrangement for sealing the covers and lockable doors. The panel shall be completely dust tight and vermin proof and shall be painted with anti-corrosive and anti-condensation type two coats of primer and two coats of paint conforming to Degree of Protection for enclosure shall be IP-55. All wiring shall be PVC insulated and PVC sheathed of 1100-volt grade of required size. The panel should have provision of entry of cable at the bottom and also provision of outgoing feeders from the bottom of the panel. The panel shall be incorporated with single copper busbarsystem. The bus bar shall be of high-quality copper of uniform cross section. The panel shall consist of the following items (viz. Voltmeter, Ammeter, CT, indicating lamps, selector switch etc.) connected as per drawing and shall be flush mounted on the front of the panel.	Set	1
	Incommer:		
a)	500 A ,4P, MCCB, 36 KA	Nos	2
b)	500 A, 4P, on-load Changeover switch	Nos	1
c)	Digital Ammeter	Nos	2
d)	Digital Voltmeter	Nos	2
e)	CT 500/5	Sets	1
f)	CT 500	Sets	1
g)	Switch Fuse Unit	Nos	6
h)	Selector Switch	Nos	4
i)	LED Indicating Lamp	Sets	2
j)	Bus-Bars: 960 A TPN electrolytic Copper Bus Bar of uniform cross-section (60mmx10mm)	Sets	1
	Outgoing:		
k)	250 A 4P MCCB 36 KA	Nos	1
l)	40 A 4P MCCB 25 KA	Nos	1
m)	100 A 4P MCCB 25 KA	Nos	1
n)	63 A 4P MCCB 25 KA	Nos	1
o)	160 A 4P MCCB 25 KA	Nos	2
p)	40 A 4P MCB	Nos	2
2	Supply, Installation antistatic rubber mat suitable for 1.1 KV Voltage grade	Sq.M	2
3	Supply, Fitting Fixing of Shock Treatment Chart	Each	4

Sister Rox Kogathakara

SECRETARY
Mendipathar Multipurpose
Co-op Society Ltd

Sjay

Shanta



Lucky Prasad & Monin





EREC India Research Laboratory

[an ISO/IEC 17025:2017 Accredited & ISO 9001:2015 Recognized Laboratory]



TEST REPORT

(Water Report)

Ref. No.: EREC/DW/2021/061

Report Date : 20/08/2021
Form No.: EREC/FM/53

Customer Name	Megha Food Co –operative Society	Sample ID. No.	DW-21/061
Address & Ph:	Mendipathar, Meghalaya		
Location Of Sample	Mendipathar, Meghalaya	Source	Bore Well
Sampling By	Client	Sample Quantity	1 ltr
Condition Of Sample	Good	Date of Sample Collection	18/08/2021
Sample Received Date	18/08/2021	Test Start Date	18/08/2021
Customer Reference No.	Nil	Test Completed On	20/08/2021

PHYSICAL AND CHEMICAL ANALYSIS :

Sl. No.	Test Parameters	Test Method	Unit	Requirement (Max. Desirable Limit) (As per IS 10500:2012)	Result
1.	Odour	IS 3025(pt-5):1983,Reaff 2002	-----	Agreeable	Agreeable
2.	Turbidity (NTU)	IS 3025(pt-10):1984,Reaff 2002	NTU	1	0.27
3.	pH value	IS 3025(pt-11):1983,Reaff 2002, Electrometric Method	-----	6.5-8.5	7.1
4.	Total Dissolved Solids	IS 3025(pt-16):1984, Reaff 2006	mg/l	500	48
5.	Residual free chlorine	IS3025(pt-26):1986,Reaff2003, Iodometric Method	mg/l	0.2	0.18
6.	Total Hardness	IS 3025 EDTA Titrimetric Method	mg/l	200	15.2
7.	Iron	IS 3025(pt-53):2003 1,10 Phcnanthroline Method	mg/l	0.3	0.001
8.	Chloride	IS 3025(pt-32):1988,Reaff 2002,Argentometric Method	mg/l	250	7.99
9.	Fluoride	APHA 23 rd Edition 4500 F-D. SPADNS Method	mg/l	1.0	0.08
10.	Calcium	IS3025(pt-40): 1991, Reaff 2003,EDTA Titrimetric Method	mg/l	75	4.56
11.	Magnesium	IS3025(pt-46):1994,Reaff2003, Volumetric Method usingEDTA	mg/l	30	6.52
12.	Sulphate	IS3025(pt-24):1986, Reaff 2003 Turbidity Method	mg/l	200	12.17
13.	Arsenic	IS 3025:1988 (Part 37) Reaff 2003	mg/l	0.01	0.007



Corporate Office : MPG Complex, R-2 Rupnagar, Guwahati – 781032, Assam.
Hello : 90850-66613, 98640-66613, E-mail : mpguw2@rediffmail.com,



Page 1 of 2

GROUND WATER TEST REPORT

Shri. R. K. Kalyankar

SECRETARY
Mendipathar Multipurpose
Co-op Societv Ltd

Sjay

Shri. K.





Erec India Research Laboratory

[An ISO 9001:2008 & ISO/IEC 17025:2017 Accredited Laboratory]

Ref. No.: EREC/DW/2021/061

PHYSICAL AND CHEMICAL ANALYSIS :

14.	Alkalinity	IS 3025(pt-23):1986,Reaff 2003	mg/l	200	8
15.	Sodium	APHA 23 rd Edition 3500-Na B Flame Emission Photometric Method	mg/l	200	10.61
16.	Potassium	APHA 23 rd Edition 3500-K B Flame Emission Photometric Method	mg/l	9.14
17.	Manganese	IS 3025(pt-59):2006	mg/l	0.1	0.04

*** END OF THE REPORT ***



EREC

Authorized Signatory

Dr. M. Pathak
CEO cum T M

N.B: 1. Result corresponds to sample submitted only 2). This report is prepared based upon the test results only.

Disclaimer

The Sample(s) to which the findings recorded herein (the "Findings") relate was (were) drawn and / or provided by the client or by a third party acting at the client's direction. The Findings constitute no warranty of the sample's representativeness of any goods and strictly relate to the sample(s). The company accepts no liability with regard to the origin source from which the sample(s) is/are said to be extracted. This document is issued by the company under its General Conditions of service printed aforesaid or available on request and accessible at <http://www.sgs.com> Page 2 of 2.

Attention is drawn to the limitation of liability, indemnification and jurisdiction issues defined therein. Any holder of this document is advised that information contained herein reflects the company's findings at the time of its intervention only and within the limits of Client's instructions, if any. The company's sole responsibility is to its Client and this document does not exonerate parties to a transaction from exercising all their rights and obligations under the transaction documents. Any unauthorized alteration, forgery or falsification of the content or appearance of this document is unlawful and offenders may be prosecuted to the fullest extent of the law. Unless otherwise stated the results shown in this test report refer only to the sample(s) tested and such sample(s) are retained for 7 days (in case of perishable items) and 30 days for all others samples. The samples from registry bodies are to be retained as specified. This document cannot be reproduced except in full, without prior written approval of the company.

Corporate Office : MPG Complex, R-2 Rupnagar, Guwahati – 781032, Assam.
Hello : 90850-66613, 98640-66613, E-mail : mpguw2@rediffmail.com

Shri. R. K. Kogathakara

SECRETARY
Mendipathar Multipurpose
Co-op Sociaty Ltd

Sjay

Shri. S.



Tender No - SFURTI-I/MGH-MMCS/ P&M-001/2021-22 - Supply, Installation And Commissioning Of Oyster Mushroom Spawn Lab, Processing & Value Addition Cluster at Mendipathar, North Garo Hills, Meghalaya

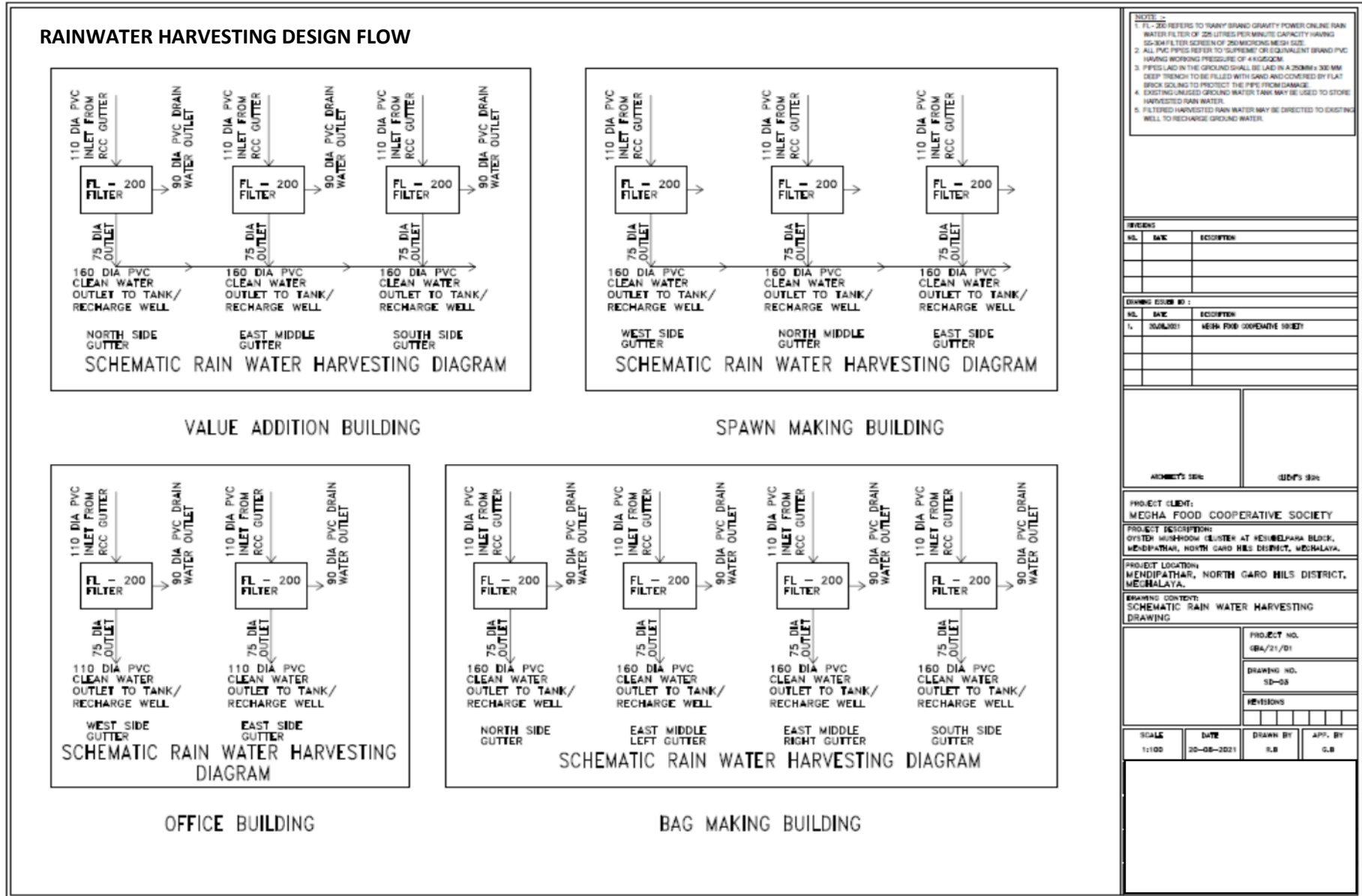

Sister Rox Kogathakara

SECRETARY
Mendipathar Multipurpose
Co-op Society Ltd

Sjay

Shreeta

Luckyfrancy a Monin